

THIS SHEET INCLUDES FITTING INSTRUCTIONS FOR THE FOLLOWING PARTS:

Secondary Alternator Cover Part No. EC-GSXR600-K6-1-GBR / Secondary Clutch Cover Part No. EC-GSXR600-K6-2-GBR /
 Secondary Starter Cover Part No. EC-GSXR600-K6-6-GBR
 Bullet Frame Race Slider Set **K6-K10** - RACE - Part No. FS-GSXR600-K6-R / Bullet Frame Race Slider Set **L1-L6** - RACE - Part No. FS-GSXR600-K11-R

SECONDARY ALTERNATOR COVER PART NO. EC-GSXR600-K6-1-GBR

- 1 Remove the Fairing.
- 2 Remove 4 off existing bolts on the stock aluminium Alternator cover, corresponding to the STOCK Secondary Engine Alternator Cover. Shown as bolt positions 1,2,3 & 4.
- 3 Place the Secondary Engine Alternator cover over the stock aluminium alternator cover. Loosely screw down all Bolt using the supplied M6 x 55mm Hex Head Flange replacement bolts.
- 4 Tighten all 4 bolts to a torque of 10 N/m as per manufacturer's recommendations. **DO NOT OVERTIGHTEN**
- 5 Refit the fairing.

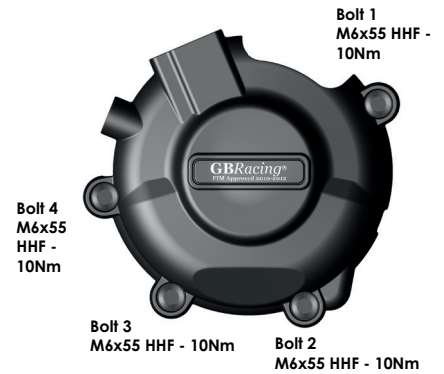
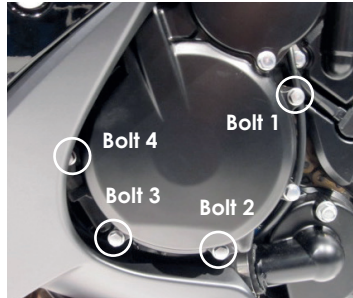

SECONDARY CLUTCH COVER PART NO. EC-GSXR600-K6-2-GBR

- 1 Remove 4 off existing bolts on the stock aluminium Clutch cover, corresponding to the Secondary Engine Clutch Cover. Shown as bolt positions 1,2,3 & 4.
- 2 Place the Secondary Engine Clutch cover over the stock aluminium clutch cover. Loosely screw down all Bolts using the supplied M6 x 35mm Hex Head Flange replacement bolts.
- 3 Tighten all 4 bolts to a torque of 10 N/m as per manufacturer's recommendations. **DO NOT OVERTIGHTEN**

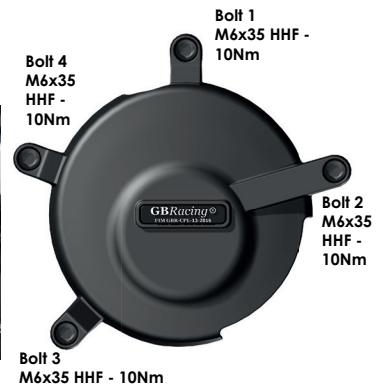
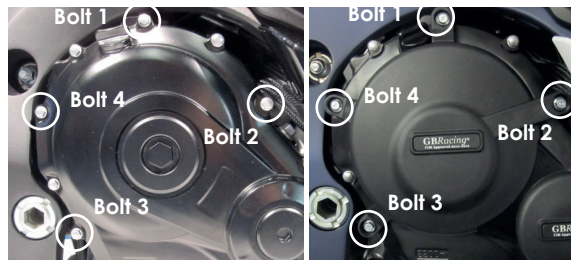

SECONDARY STARTER COVER PART NO. EC-GSXR600-K6-6-GBR

- 1 Remove 3 off existing bolts on the stock aluminium Starter cover, corresponding to the Secondary Engine Starter Cover. Shown as bolt positions 1,2 & 3.
 Note: Retain the 1 Rubber Washer found at Bolt Position 1.
- 2 Assemble 1 of the supplied M6x35mm Hex Head Flanged Bolts through the Secondary Engine Starter Cover at Bolt Position 1.
 Place the retained rubber washer over the threaded end of this bolt.
- 3 Place the Secondary Engine Starter Cover over the stock aluminium starter cover. Loosely screw down Bolt 1, then the remaining Bolts as supplied M6 x 35mm Hex Head Flange bolts.
- 4 Tighten all 4 bolts to a torque of 10 N/m as per manufacturer's recommendations. **DO NOT OVERTIGHTEN**

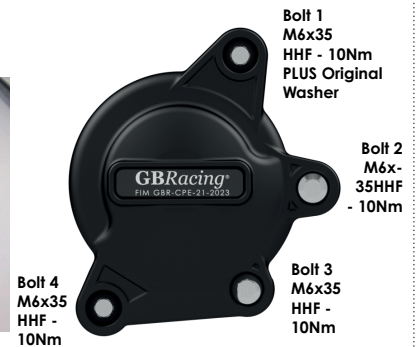
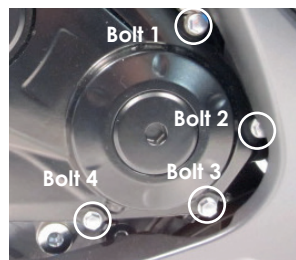

BULLET FRAME SLIDER - LEFT HAND SIDE - RACE - K6-L0
PART NO. FS-GSXR600-K6-LHS-R

NOTE: FAIRING REQUIRES MODIFICATION

- 1 Remove fairing from bike.
- 2 Extend upper engine mount bolt as seen in picture 1.
- 3 Replace fairing and mark bolt position on inside of fairing.
- 4 Remove fairing from bike and drill clearance hole of 22mm as seen in picture 2.
- 5 Remove upper engine mount bolt.
- 6 Replace fairing as seen in picture 3.
- 7 Assemble bolt through the aluminium bush into correct position.
- 8 Tighten to 55NM torque.
- 9 Slide bullet moulding onto aluminium bush.
- 10 Screw M6 bolt into front of bullet moulding hand tight.

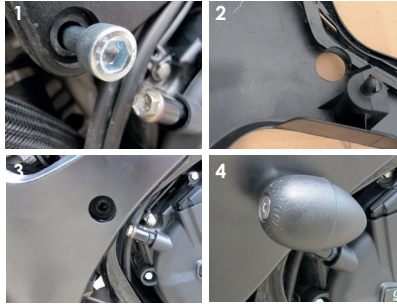

BULLET FRAME SLIDER - RIGHT RIGHT SIDE - RACE - K6-L0
PART NO. FS-GSXR600-K6-RHS-R

- 1 Remove upper engine mounting bolt, located through the fairing opening.
- 2 Assemble bolt through the aluminium bush into correct position.
- 3 Tighten to 55NM torque.
- 4 Slide bullet moulding onto aluminium bush.
- 5 Screw M6 bolt into front of bullet moulding hand tight.



BULLET FRAME SLIDER SET - RACE - L1-L9
PART NO. FS-GSXR600-K11-R

NOTE: ON L2 MODEL THE RIGHT HAND SIDE REQUIRES FAIRING MODIFICATION

- 1 Remove fairing from bike.
- 2 Extend upper engine mount bolt as seen in picture 1.
- 3 Replace fairing and mark bolt position on inside of fairing.
- 4 Remove fairing from bike and drill clearance hole of 22mm as seen in picture 2.
- 5 Remove upper engine mount bolt.
- 6 Replace fairing as seen in picture 3.
- 7 Assemble bolt through the aluminium bush into correct position.
- 8 Tighten to 25NM torque.
- 9 Slide bullet moulding onto aluminium bush.
- 10 Screw M6 bolt into front of bullet moulding hand tight.

LEFT HAND SIDE:



RIGHT HAND SIDE:

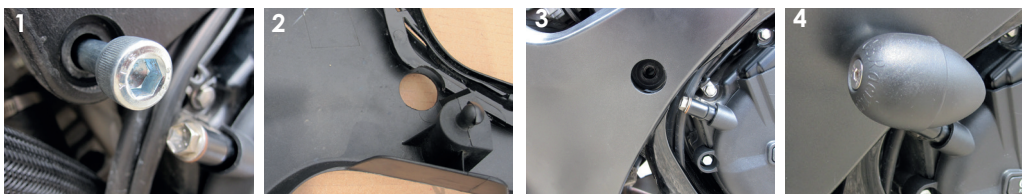
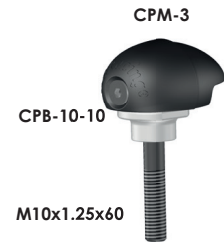

SETS & BUNDLES

Protection Bundle: CP-GSXR600-K6-CS-GBR

EC-GSXR600-K6-1-GBR, EC-GSXR600-K6-6-GBR, EC-GSXR600-K6-2-GBR, BA12-8-GBR-SET, CGA10-GBR

Engine Cover Set: EC-GSXR600-K6-SET-GBR

EC-GSXR600-K6-1-GBR, EC-GSXR600-K6-6-GBR, EC-GSXR600-K6-2-GBR

Frame Slider Set K6-K10: FS-GSXR600-K6-R:

FS-GSXR600-K6-LHS-R, FS-GSXR600-K6-RHS-R

Frame Slider Set L1-L6: FS-GSXR600-K11-R (Parts only available as a SET)